

ART 191 PN25

PN25 Ductile Iron Swing Check Valve, Lever, Weight & Damper

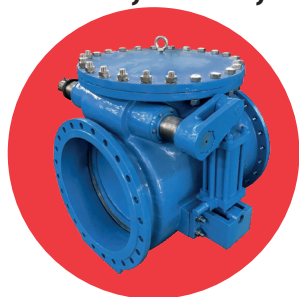

Features

- Flange Mounting PN25 only
- Flange conforms to BS EN1092 PN25
- Face to face conforms with DIN 3202 F6
- Fusion bonded Epoxy coat finish

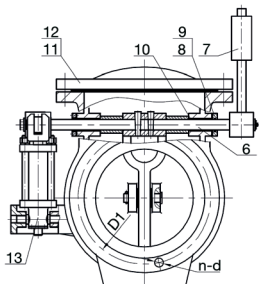

For sizes
DN80 - DN250

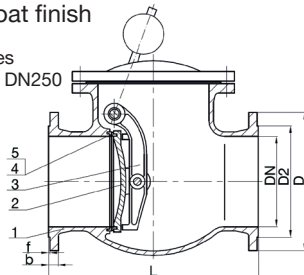

For sizes
DN300 - DN600

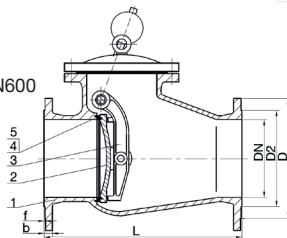

Technical data

Max pressure: 25 Bar
Working temp: -10°C to +80°C

DN	300	350	400	450	500	600
L	700	800	900	1000	1100	1300
D	485	555	620	670	730	845
D1	430	490	550	600	660	770
D2	389	448	503	548	609	720
b	27.5	30.0	32.0	34.5	36.5	42.0
n-d	16-31	16-34	16-37	20-37	20-37	20-41
f	4	4	4	4	4	5
Kgs	353	491	622	738	915	1430

N.	Part Name	Materials
1	Body	Ductile Iron EN-GJS:500-7
2	Disc	Ductile Iron EN-GJS:500-7
3	Rocker	Ductile Iron EN-GJS:500-7
4	Disc Sealing Ring	Gunmetal LG2
5	Body Sealing Ring	Gunmetal LG2
6	Shaft	Stainless Steel 420
7	Lever & Weight	
8	Cover	Ductile Iron EN-GJS:500-7
9	O-Ring	EPDM
10	Bushes	Stainless Steel + PTFE
11	Bonnet	Ductile Iron EN-GJS:500-7
12	O-Ring	EPDM
13	Damping Cylinder	

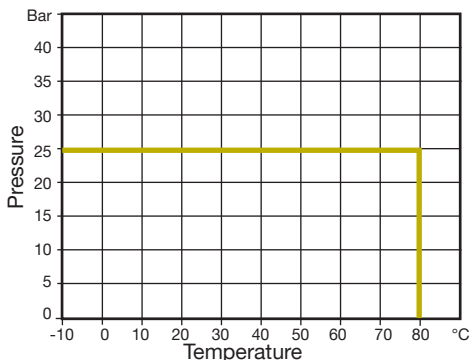

V1. Dimensions in mm

This data sheet is designed as a guide and should not be regarded as wholly accurate in every detail. We reserve the right to amend the specification of any product without notice.