

# ART 34NPT

## Thermostatic Mixing Valve (TMV)



### Features

- Cold water supply temperature 4°C - 27°C
- Hot water supply temperature 49°C - 82°C
- Temperature adjustment range 30°C - 49°C
- Factory temperature setting 41°C ±2°C
- Mix temperature stability 1.7°C
- Max supply pressure 125psi
- Temperature differential 10°C
- Maximum temperature 90°C
- Flow rate minimum 4 litres/min (1gpm)
- ASSE 1017 Approved



### Technical data

Max supply pressure 125psi  
Temp adjustment range 30°C to 49°C

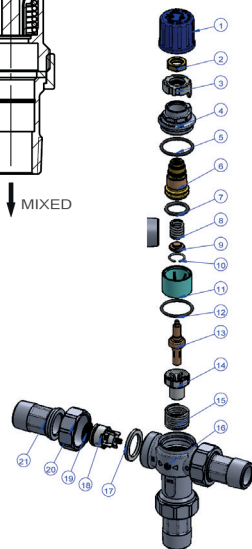
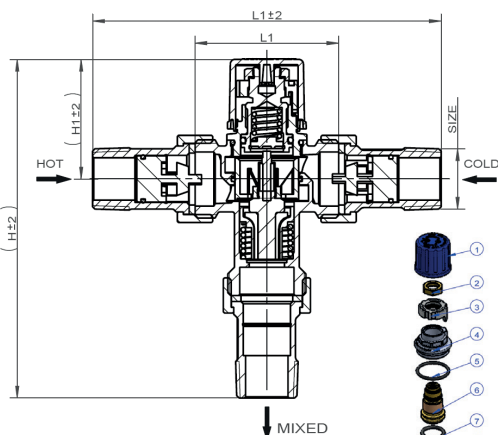

### N. Part Name Materials

N.	Part Name	Materials
1	Cap	ABS
2	Locking Cap	Brass C46500
3	Locating Ring	POM+25%GF
4	Bonnet	Brass C46500
5	O-Ring	EPDM WRAS approved
6	Stem	Brass C46500
7	O-Ring	EPDM WRAS approved
8	Spring	Stainless Steel 304
9	Block	Brass C46500
10	Circlip	Stainless Steel 304
11	Piston	PSU
12	O-Ring	EPDM WRAS approved
13	Thermostat	Assembly
14	Water Flow Directors	PSU
15	Spring	Stainless Steel 304
16	Valve Body	Brass C46500
17	Gasket	EPDM WRAS approved
18	Check Valve	Acetal
19	Strainer	Stainless Steel 304
20	Union Nut	Brass C37700
21	Connect Pipe	Brass C46500

DN	1/2"	3/4"
H	136.3	143.8
H1	50.8	50.8
L	135	146
L1	59	61
Kgs	0.51	0.73

V1. Dimensions in mm

This data sheet is designed as a guide and should not be regarded as wholly accurate in every detail. We reserve the right to amend the specification of any product without notice.