

# ART 460

## NBR PN16 Tied

### Flanged Flexible Connector

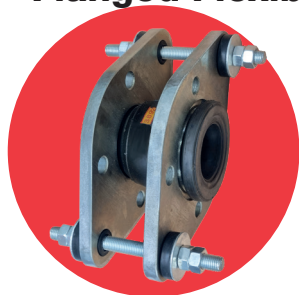

#### Features

- Flanged PN16 BS4504
- Zinc plated carbon steel oval flanges
- Nylon cord fabric with steel reinforcement
- Available with EPDM body

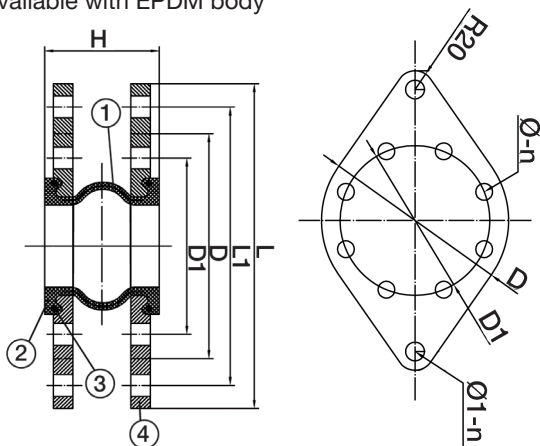

#### Technical data

Max pressure: 16 Bar

Working temp: -20°C to +80°C

N.	Part Name	Materials
1	Body	NBR
2	Reinforcement	Nylon Cord Wire
3	Pressure Ring	Steel Wire
4	Flange	Carbon Steel

DN	32	40	50	65	80	100	125	150	200	250	300
L	222	232	247	267	286	306	336	371	440	505	560
L1	184	194	209	229	246	266	296	331	393	458	513
D	140	150	165	185	200	220	250	285	340	405	460
D1	100	110	125	145	160	180	210	240	295	355	410
H	130	130	130	130	130	130	130	130	130	130	130
Ø-n	18-4	18-4	18-4	18-4	18-8	18-8	18-8	22-8	22-12	26-12	26-12
Ø1-n	18-2	18-2	18-2	18-2	20-2	20-2	20-2	20-2	27-2	27-2	27-2
HD	12	12	12	12	12	12	12	12	12	12	12
DA	15°	15°	15°	15°	15°	15°	15°	15°	15°	15°	15°
Ext	8	8	8	8	8	8	8	8	8	8	8
Comp	15	15	15	15	15	15	15	15	15	15	15
Kgs	4.1	4.8	6.5	8.1	9.6	10.8	14.8	17.1	22.8	34.0	41.9



HD - Horizontal Displacement



DA - Deflection Angular



Ext - Extension



Comp - Compression

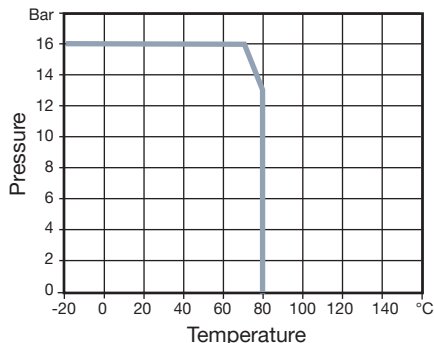

V1. Dimensions in mm

This data sheet is designed as a guide and should not be regarded as wholly accurate in every detail. We reserve the right to amend the specification of any product without notice.