

# Extension Spindle

## To suit ART 231



### Features

- Epoxy Coated Carbon Steel
- Extension to suit underground / buried resilient seated gate valve
- Comes with polyethylene pipe sleeve suiting spindle length
- Stainless Steel option also available

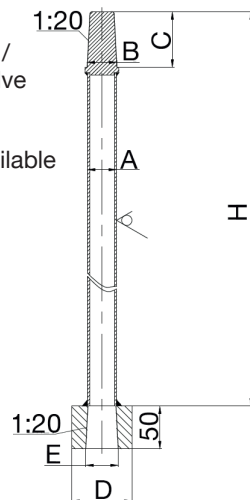

DN	DN50-DN300	DN350-DN400	DN450-DN600
A	Ø34	Ø48	Ø50
B	35	35	48
C	65	65	75
D	Ø70	Ø85	Ø85
E	35	48	48
H	----- As per customer requirement -----		

# Buried Box

## To suit ART 231 DN50-DN600



### Features

- Material construction - Ductile Iron
- Box - blue epoxy coated
- Cover - black epoxy painted

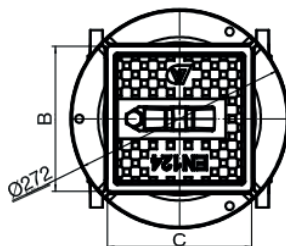
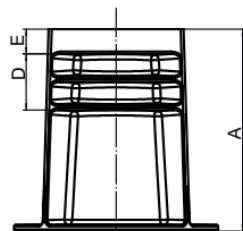

DN	DN50-DN600
A	269.5
B	180
C	180
D	75
E	33